

# 阳山县2019年度第二批城镇建设用地图

2709.1-362.0

2020H005

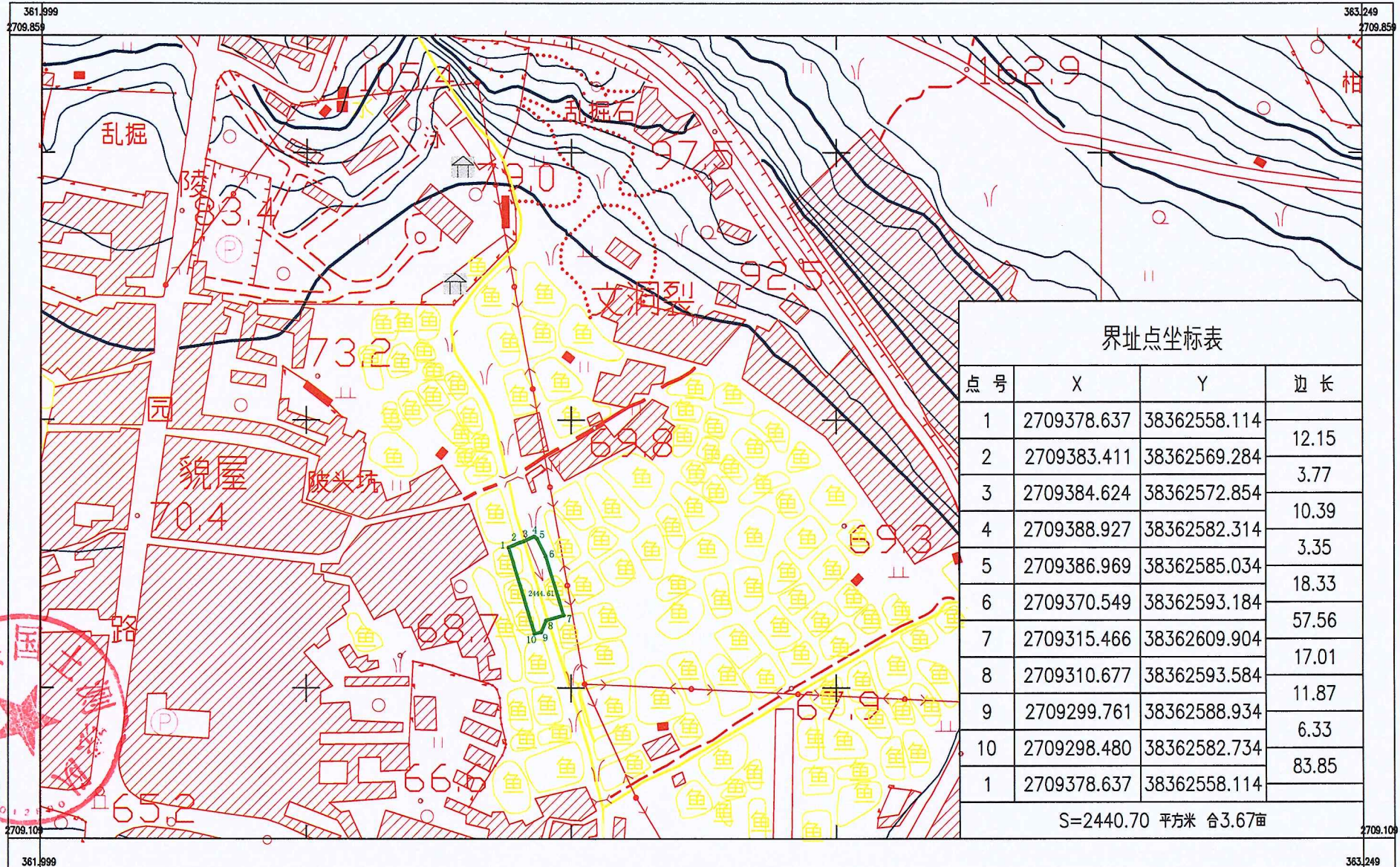
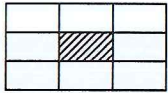

界址点坐标表

点号	X	Y	边长
1	2709378.637	38362558.114	12.15
2	2709383.411	38362569.284	3.77
3	2709384.624	38362572.854	10.39
4	2709388.927	38362582.314	3.35
5	2709386.969	38362585.034	18.33
6	2709370.549	38362593.184	57.56
7	2709315.466	38362609.904	17.01
8	2709310.677	38362593.584	11.87
9	2709299.761	38362588.934	6.33
10	2709298.480	38362582.734	83.85
1	2709378.637	38362558.114	

S=2440.70 平方米 合3.67亩



2020年2月27日  
国家大地2000坐标系, 1985国家高程基准, 等高距为 米

1:2500

# 阳山县2019年度第二批城镇建设用地图

2708.9-362.2

2020H006

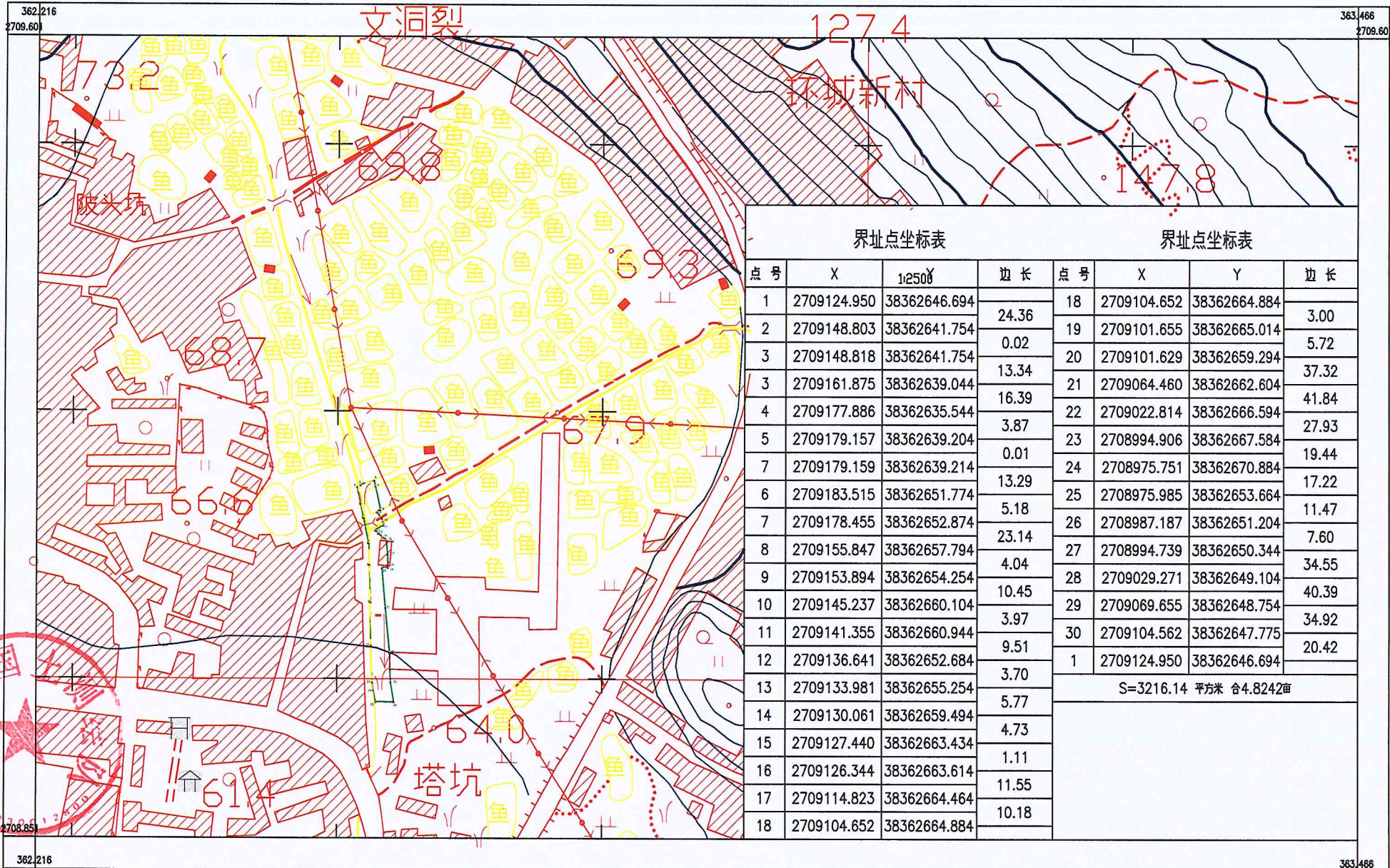
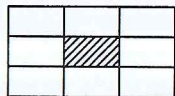

界址点坐标表				界址点坐标表			
点号	X	1:2500	边长	点号	X	Y	边长
1	2709124.950	38362646.694	24.36	18	2709104.652	38362664.884	3.00
2	2709148.803	38362641.754	0.02	19	2709101.655	38362665.014	5.72
3	2709148.818	38362641.754	13.34	20	2709101.629	38362659.294	37.32
3	2709161.875	38362639.044	16.39	21	2709064.460	38362662.604	41.84
4	2709177.886	38362635.544	3.87	22	2709022.814	38362666.594	27.93
5	2709179.157	38362639.204	0.01	23	2708994.906	38362667.584	19.44
7	2709179.159	38362639.214	13.29	24	2708975.751	38362670.884	17.22
6	2709183.515	38362651.774	5.18	25	2708975.985	38362653.664	11.47
7	2709178.455	38362652.874	23.14	26	2708987.187	38362651.204	7.60
8	2709155.847	38362657.794	4.04	27	2708994.739	38362650.344	34.55
9	2709153.894	38362654.254	10.45	28	2709029.271	38362649.104	40.39
10	2709145.237	38362660.104	3.97	29	2709069.655	38362648.754	34.92
11	2709141.355	38362660.944	9.51	30	2709104.562	38362647.775	20.42
12	2709136.641	38362652.684	3.70	1	2709124.950	38362646.694	
13	2709133.981	38362655.254	5.77	S=3216.14 平方米 合4.8242亩			
14	2709130.061	38362659.494	4.73				
15	2709127.440	38362663.434	1.11				
16	2709126.344	38362663.614	11.55				
17	2709114.823	38362664.464	10.18				
18	2709104.652	38362664.884					

