

441802007016GB00003政府回收地块用地平面图

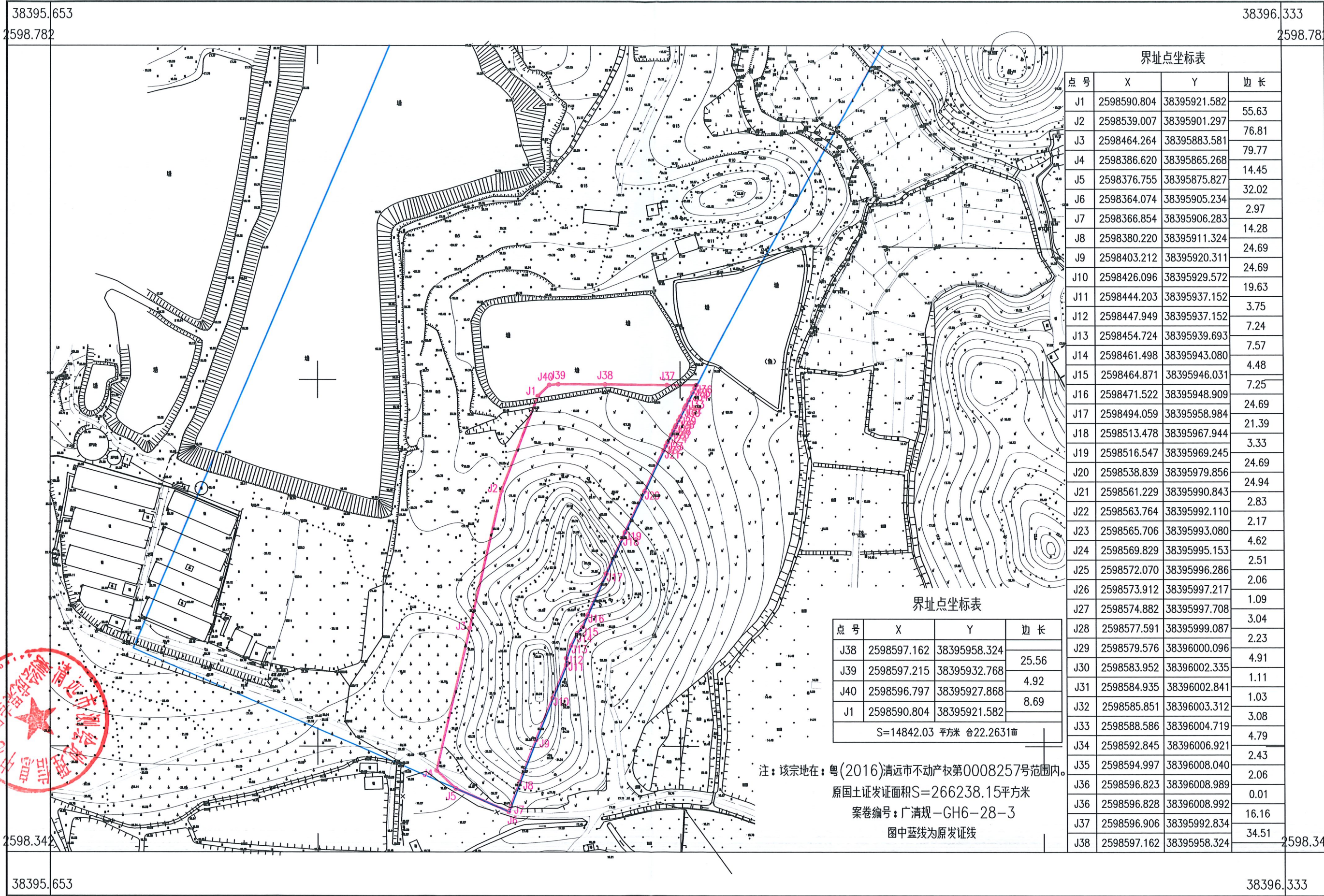

界址点坐标表

点号	X	Y	边长
J1	2598590.804	38395921.582	55.63
J2	2598539.007	38395901.297	76.81
J3	2598464.264	38395883.581	79.77
J4	2598386.620	38395865.268	14.45
J5	2598376.755	38395875.827	32.02
J6	2598364.074	38395905.234	2.97
J7	2598366.854	38395906.283	14.28
J8	2598380.220	38395911.324	24.69
J9	2598403.212	38395920.311	24.69
J10	2598426.096	38395929.572	19.63
J11	2598444.203	38395937.152	3.75
J12	2598447.949	38395937.152	7.24
J13	2598454.724	38395939.693	7.57
J14	2598461.498	38395943.080	4.48
J15	2598464.871	38395946.031	7.25
J16	2598471.522	38395948.909	24.69
J17	2598494.059	38395958.984	21.39
J18	2598513.478	38395967.944	3.33
J19	2598516.547	38395969.245	24.69
J20	2598538.839	38395979.856	24.94
J21	2598561.229	38395990.843	2.83
J22	2598563.764	38395992.110	2.17
J23	2598565.706	38395993.080	4.62
J24	2598569.829	38395995.153	2.51
J25	2598572.070	38395996.286	2.06
J26	2598573.912	38395997.217	1.09
J27	2598574.882	38395997.708	3.04
J28	2598577.591	38395999.087	2.23
J29	2598579.576	38396000.096	4.91
J30	2598583.952	38396002.335	1.11
J31	2598584.935	38396002.841	1.03
J32	2598585.851	38396003.312	3.08
J33	2598588.586	38396004.719	4.79
J34	2598592.845	38396006.921	2.43
J35	2598594.997	38396008.040	2.06
J36	2598596.823	38396008.989	0.01
J36	2598596.828	38396008.992	16.16
J37	2598596.906	38395992.834	34.51
J38	2598597.162	38395958.324	25.56

界址点坐标表

点号	X	Y	边长
J38	2598597.162	38395958.324	25.56
J39	2598597.215	38395932.768	4.92
J40	2598596.797	38395927.868	8.69
J1	2598590.804	38395921.582	

S=14842.03 平方米 合22.2631亩

注：该宗地在：粤(2016)清远市不动产权第0008257号范围内。
 原国土证发证面积S=266238.15平方米
 案卷编号：广清规—GH6—28—3
 图中蓝线为原发证线

清远市测绘地理信息中心
 2019年12月数字化成图
 2000国家大地坐标系
 1985国家高程基准
 2017年版图式

1:2000

测量员：周中莹
 绘图员：龙 聪
 检查员：周永林