

B4100506*1用地平面图

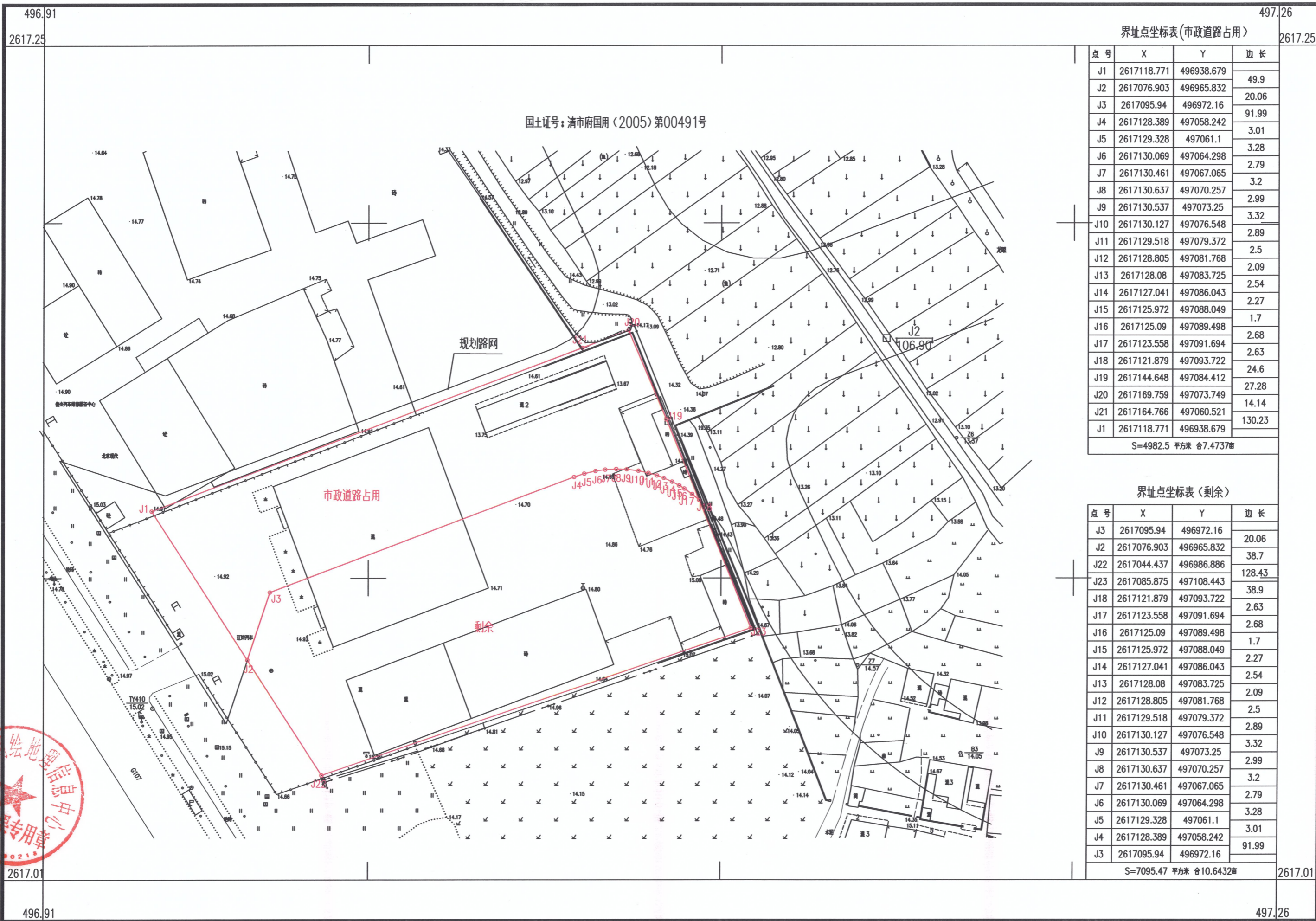

国土证号：清市府国用(2005)第00491号

界址点坐标表(市政道路占用)

点号	X	Y	边长
J1	2617118.771	496938.679	49.9
J2	2617076.903	496965.832	20.06
J3	2617095.94	496972.16	91.99
J4	2617128.389	497058.242	3.01
J5	2617129.328	497061.1	3.28
J6	2617130.069	497064.298	2.79
J7	2617130.461	497067.065	3.2
J8	2617130.637	497070.257	2.99
J9	2617130.537	497073.25	3.32
J10	2617130.127	497076.548	2.89
J11	2617129.518	497079.372	2.5
J12	2617128.805	497081.768	2.09
J13	2617128.08	497083.725	2.54
J14	2617127.041	497086.043	2.27
J15	2617125.972	497088.049	1.7
J16	2617125.09	497089.498	2.68
J17	2617123.558	497091.694	2.63
J18	2617121.879	497093.722	24.6
J19	2617144.648	497084.412	27.28
J20	2617169.759	497073.749	14.14
J21	2617164.766	497060.521	130.23
J1	2617118.771	496938.679	
S=4982.5 平方米 合7.4737亩			

界址点坐标表(剩余)

点号	X	Y	边长
J3	2617095.94	496972.16	20.06
J2	2617076.903	496965.832	38.7
J22	2617044.437	496986.886	128.43
J23	2617085.875	497108.443	38.9
J18	2617121.879	497093.722	2.63
J17	2617123.558	497091.694	2.68
J16	2617125.09	497089.498	1.7
J15	2617125.972	497088.049	2.27
J14	2617127.041	497086.043	2.54
J13	2617128.08	497083.725	2.09
J12	2617128.805	497081.768	2.5
J11	2617129.518	497079.372	2.89
J10	2617130.127	497076.548	3.32
J9	2617130.537	497073.25	2.99
J8	2617130.637	497070.257	3.2
J7	2617130.461	497067.065	2.79
J6	2617130.069	497064.298	3.28
J5	2617129.328	497061.1	3.01
J4	2617128.389	497058.242	91.99
J3	2617095.94	496972.16	
S=7095.47 平方米 合10.6432亩			

